

KAPPA DESTEMMER-CRUSHERS

Models

- Kappa 15
- Kappa 25
- Kappa 50
- Kappa 60
- Kappa 90
- Kappa 150

Technical description

This machine is designed for processing whole bunches or mechanically harvested.

Frame and carpentry completely made of AISI 304 stainless steel.

Emergency devices and for user's safety, in compliance with European Directive 2006/42/CE (Machinery).

Control panel in accordance with European Directive 2006/95/CE (LV) and 2004/108/CE (EMC).

This machine consists of two independent units: destemming unit and crushing unit.

Destemming unit

The destemming unit is composed of a cage with drawn holes, inside of which the beater rotates. Both of them are made of AISI 304 stainless steel. Cages with different sizes and holes are available. The distance and inclination of beater elements are mechanically adjustable. The beater and cage speeds are adjustable by means of an Inverter.

Crushing unit

The crushing unit consists of two food grade rubber crushing rollers. Each roller is stamped in only one piece in order to make hygiene and cleaning operation easy. The distance between the rollers is adjustable in order to avoid seed crushing and to ensure a correct berry crushing.

The combined rotation and the possibility of regulation allow the highest flexibility and quality of the product manufactured.

This crushing unit can be removed to make the cleaning easy and for non-crushing option based on winery requirements.

OPTIONS	KAPPA 15	KAPPA 25	KAPPA 50	KAPPA 60	KAPPA 90	KAPPA 150
Draining hopper	●	●	●	●	●	X
Raised feet 589 mm long	●	X	X	X	X	X
Onboard control panel for destemmer	standard	●	X	X	X	X
Draining hopper with double screw and double motor with Inverter	X	X	X	X	X	●
Machine on wheels	standard	●	X	X	X	X

● available

X not available

Drawing

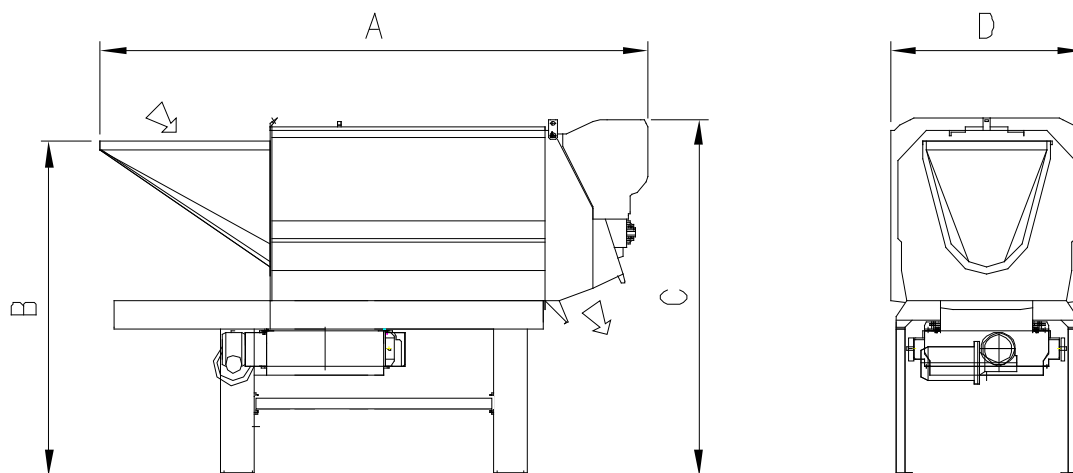

TECHNICAL DATA	KAPPA 15	KAPPA 25	KAPPA 50	KAPPA 60	KAPPA 90	KAPPA 150
A (mm)	2300	2824	3220	3240	3720	5341
B (mm)	1460	1690	1965	2033	2224	2704
C (mm)	1575	1857	2100	2276	2575	3250
D (mm)	840	940	1130	1236	1350	1800
Empty weight (kg)	410	700	1000	1600	1750	2500
Installed power (kW/50Hz)	2.25	5,2	9,5	11,5	15	53
Working capacity (ton/h)	8 - 13	18 - 25	38 - 45	50 - 65	75 - 90	150